

FILTER OVERVIEW WITH SERVICE INTERVALS AND CAPACITIES

5E Tier 2, Tier 3, iT4 and FT4 Series Utility Tractors (North American Version) – 5045E, 5055E, 5065E, 5075E

CAB (If Equipped)

FRESH AIR FILTER (2)
[RE198488](#)

RECIRCULATION AIR FILTER (2)
[RE195491](#)

RECIRCULATION W/O A.C. AIR
FILTER – [R198887](#)

Clean after every 500 hours and
change every 1200 hours.

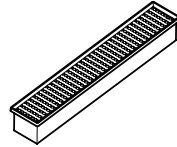

ENGINE (If Equipped)

DIESEL PARTICULATE FILTER
(DPF) [RE567056](#)

Replace as required.

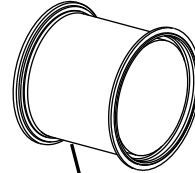

ENGINE AIR

PRIMARY AIR FILTER
(T2, iT4, FT4 ENGINE) [RE282286](#)
(PRE-EMISSION TRACTORS) [SU29300](#)

SECONDARY AIR FILTER
(T2, iT4, FT4 ENGINE) [RE282287](#)
(PRE-EMISSION TRACTORS) [SU29301](#)

Service after every 250 hours or annually,
and as required per conditions.

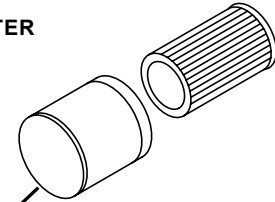

HYDRAULIC

OIL FILTER [RE45864](#)

Replace after initial 100 hours,
then every 250 hours and every
1200 hours.

(Click here for [capacity](#))

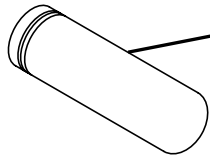

ENGINE

OIL FILTER [RE519626](#)

Replace after initial 100 hours, then
every 250 hours or annually.

If Plus-50™ II oil and John Deere™
filter is used interval may be extended
to 500 hours.

(Click here for [capacity](#))



ENGINE

FUEL FILTER
[RE60021](#) (Tier 2, iT4)
[R536698](#) (FT4)

Replace after every 500 hours.

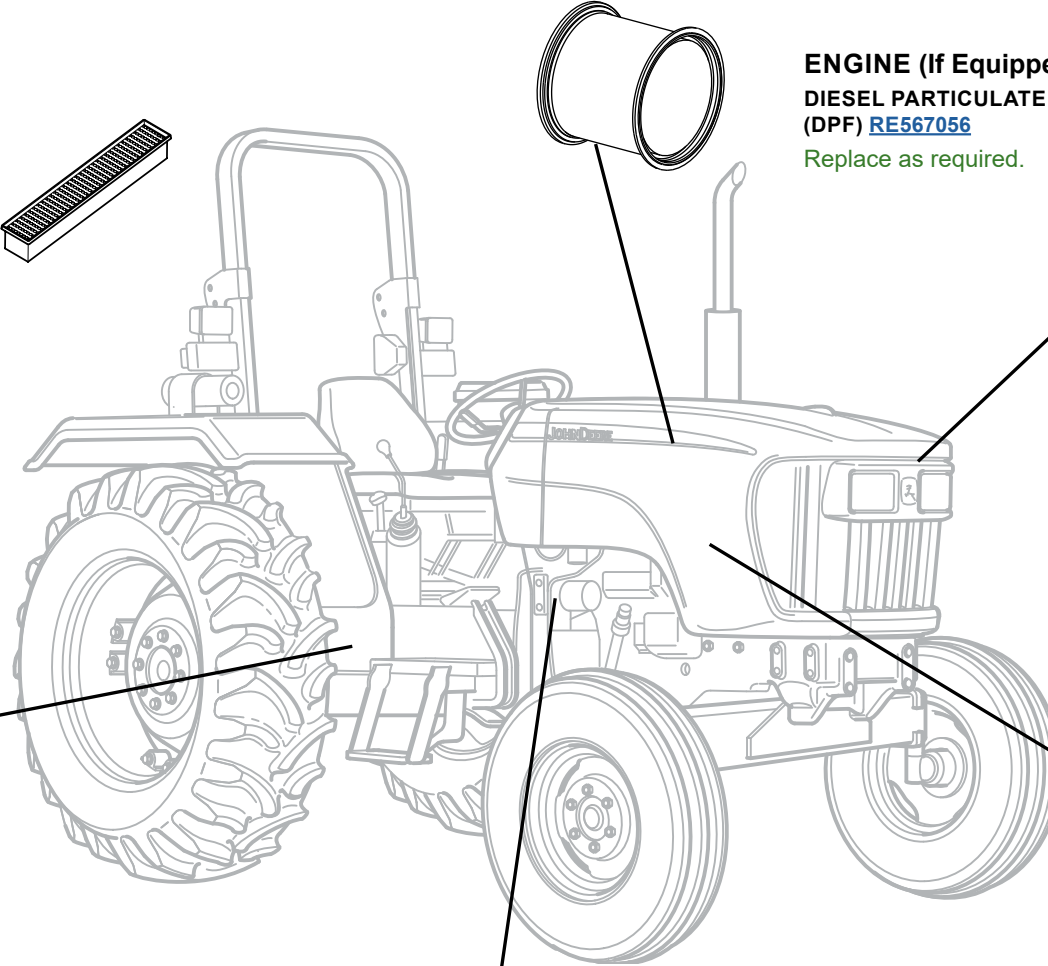

JOHN DEERE

Genuine Parts and Service

CAPACITIES

5E Tier 2, Tier3, iT4 and FT4 Series Utility Tractors (North American Version) – 5045E, 5055E, 5065E, 5075E

CAPACITIES (Approximate):

Fuel Tank:

Open Station.....	68 L (18 gal)
Cab.....	82 L (21.6 gal)

Cooling System:

Cool-Gard™ II

.....	9.5 L (2.5 gal)
-------	-----------------

Engine Oil:

Plus-50™ II

.....	8.5 L (2.24 gal)
-------	------------------

Transmission and Hydraulic System Oil:

Hy-Gard™

Trans Sync Shuttle	38 L (10 gal)
PowrReverser.....	43.5 L (11.5 gal)

Mechanical Front Wheel Drive (MFWD):

Hy-Gard™

Wheel Hub (Each)	0.8 L (0.21 gal)
Axle Housing	4.5 L (1.18 gal)

[Return to Filter Overview](#)

